

# BHS150 Board Handling System

## Expanding your production capacity

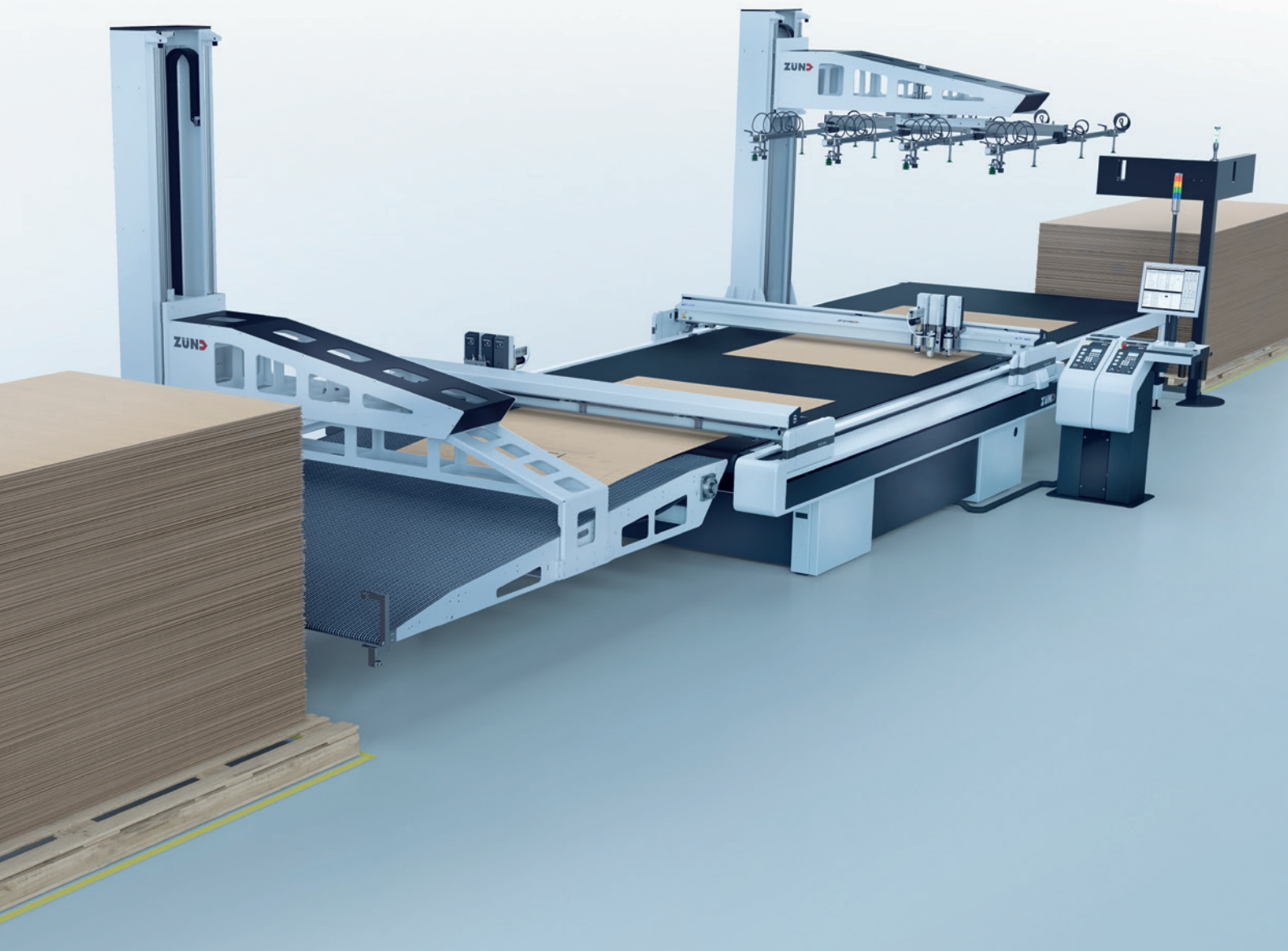

Your first choice in digital cutting.

# Digital cutting at an industrial level

## The new BHS150 Board Handling System

The unique combination of fully automated material handling and powerful digital cutting capabilities is key to producing at an industrial level. The Zünd BHS150 extends operating time while decreasing operating costs.



**Ideal for different material thicknesses**  
The BHS150 can efficiently process material thicknesses up to 110 mm.



**Economical even for smaller formats**

The load unit can feed multiple sheets at once to make full use of the cutting area. This ensures maximum throughput even with smaller-format media.

**Automatic job retrieval**

During loading, the system automatically scans printed QR codes and retrieves corresponding file information. This enables reliably identifying different jobs within a stack for fully automated, non-stop

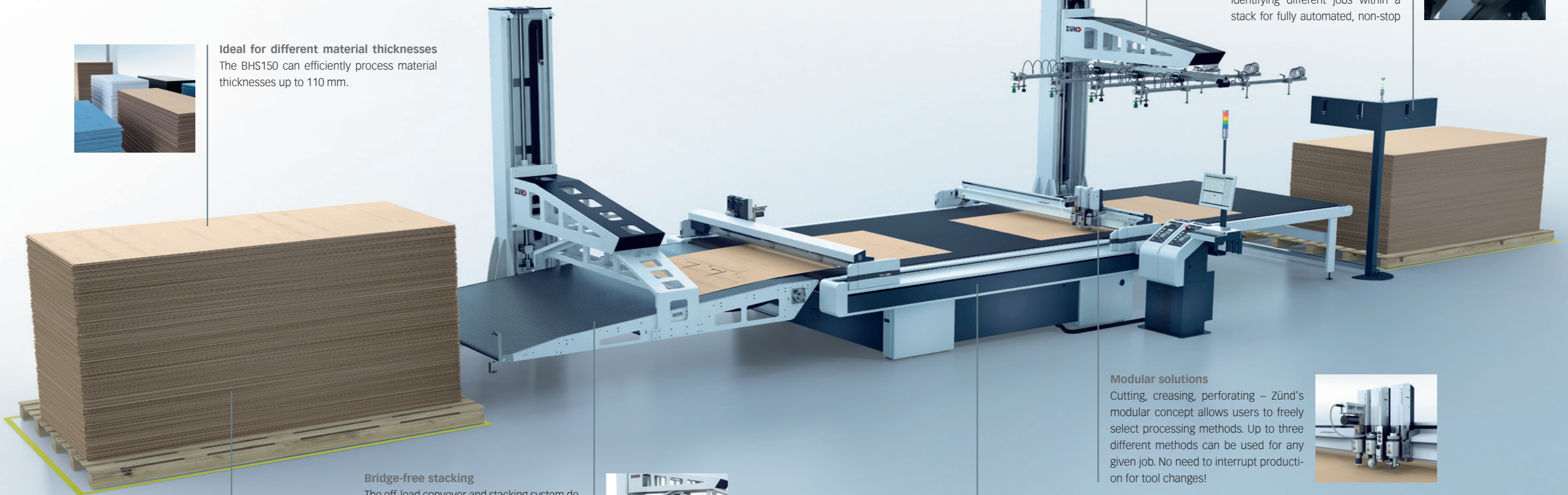

**Bridge-free stacking**

The off-load conveyor and stacking system deposits cut boards in a perfect stack on the pallet. Depending on the job, this stacking process eliminates the need for bridges to hold cut pieces in place. This facilitates separating cut parts from scrap, saving both time and money.

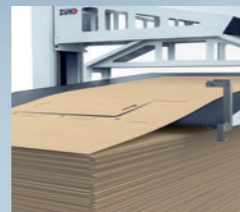

**Modular solutions**

Cutting, creasing, perforating – Zünd's modular concept allows users to freely select processing methods. Up to three different methods can be used for any given job. No need to interrupt production for tool changes!

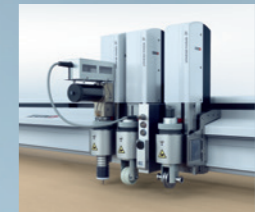

**Efficient stacking with the BHS150**

The stack height of 1.5m allows much longer uninterrupted operating time: long runs are finished efficiently and economically while finished stacks can be removed without interrupting the production process.

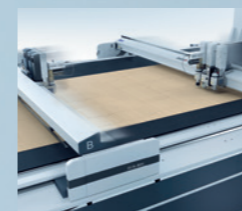
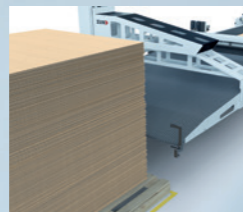

**Top speed for maximum productivity**

The BHS150 is designed for operation with the Zünd G3 and D3 cutter series. D3 dual-beam technology provides a significant increase in performance and thus offers maximum productivity.



# Technical data

01/2020

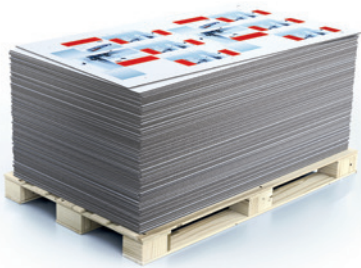

Loading	Board Handling System – BHS150			
<b>max. board size</b>	1800 × 3200 mm (L line)	2270 × 3200 mm (XL line)	2740 × 3200 mm (2XL line)	3210 × 3200 mm (3XL line)
<b>max. board thickness</b>	110 mm (depending on beam height)			
<b>max. board weight</b>	25 kg (per piece)			
<b>max. stack height</b>	1500 mm (incl. pallet)			

## Separating unit (Optional)

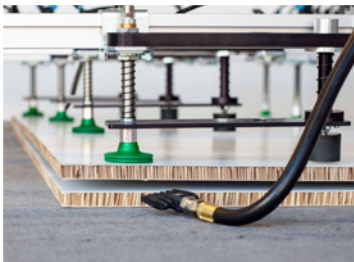

Additional separating unit (rear) for reliable separation of panel material, consisting of four bellows suction units and two separating nozzles:

Examples:

- Electrostatically charged panel material
- Printed panel material
- Sandwich board

**Zünd Systemtechnik AG**  
Industriestrasse 8  
CH-9450 Altstätten  
T +41 71 554 81 00  
info@zund.com  
www.zund.com

**ZÜND**  
swiss cutting systems